



Sunis indoor WireFree™ RTS

Ref. 5066683A

- EN Installer Guide
- ES Manual para instalador
- PT Guia do Instalador
- EL Οδηγός τεχνικού εγκατάστασης

HOME MOTION by



CONTENTS

1. Introduction	2
2. Safety	2
2.1. Safety and liability	2
2.2. Specific safety advice	3
3. Contents	4
4. The Sunis indoor WireFree™ RTS in detail	4
5. Commissioning	5
5.1. (OFF/☀) selector switch	5
5.2. Adding/Deleting a Sunis Indoor WireFree™ RTS	5
5.3. Positioning of the Sunis Indoor WireFree™ RTS	6
5.4. Sunlight simulation	7
5.5. (Mode) button	8
5.6. Setting the sunlight threshold	9
6. Use	10
7. Tips and recommendations	12
7.1. Questions about the Sunis Indoor WireFree™ RTS?	12
7.2. Replacing the battery	13
8. Technical data	14

1. Introduction

The Sunis Indoor WireFree RTS is a wireless solar sensor that transmits radio signals using Radio Technology Somfy (RTS). Depending on the detected level of sunlight intensity, the sensor sends a raise or lower order to the motors or RTS receivers. This permits automatic control of the sun protection end-products that protect your interiors (e.g. your furniture, plants, etc.) and to assist you in saving energy (in summer only).

2. Safety

2.1. Safety and liability

Before installing and using this product, please read this guide carefully.

This Somfy product must be installed by a professional motorisation and home automation installer, for whom this guide is intended.

Moreover, the installer must comply with the current standards and legislation in the country in which the product is being installed, and inform the customer of the operating and maintenance conditions for the product.

Any use outside the sphere of application specified by Somfy is prohibited. Doing so would void the warranty and releases Somfy of all liability, as does any failure to comply with the instructions given herein.

Never begin installing without first checking the compatibility of this product with the associated equipment and accessories.

2.2. Specific safety advice

To avoid damage to the product:

- 1) Never immerse it in a liquid!
- 2) Avoid sharp bumps or blows!
- 3) Do not let it fall!
- 4) Never pierce it!
- 5) Do not use abrasive products or solvents to clean the product.
- 6) Keep out of the reach of children.

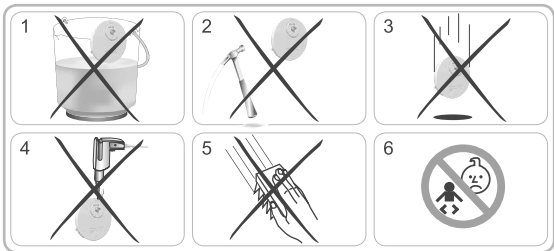

3. Contents

1	Sunis indoor WireFree™ RTS
1	Suction cup

4. The Sunis indoor WireFree™ RTS in detail

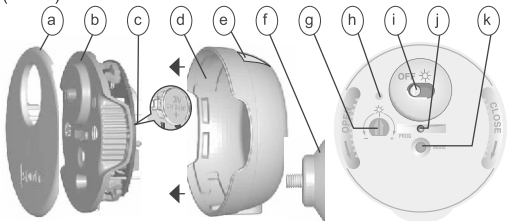

- a) Protective front cover
- b) Sun sensor
- c) Battery
- d) Rear cover
- e) Sunlight detection area
- f) Suction cup
- g) Potentiometer for setting the sunlight threshold
- h) Sun LED
- i) (OFF/☀) selector switch
- j) Programming button (PROG)
- k) (Mode) button



5. Commissioning

5.1. (OFF/☀️) selector switch

Slide the (OFF/☀️) selector switch to ☀️ to activate the sunlight sensor functions.

	
<p>Sunlight function inactive (PROG) button inactive. (Mode) button inactive. Sun LED inactive (No energy consumption).</p>	<p>Sunlight function active (sun LED glows for 5 seconds). (PROG) button active. (Mode) button active. Sun LED active.</p>

5.2. Adding/Deleting a Sunis Indoor WireFree™ RTS

- The procedure for adding or deleting a sensor is the same.
- To add or delete a Sunis Indoor WireFree™ RTS, use the RTS control point already programmed to the end-product.

- 1) Slide the (OFF/☀️) selector to ☀️.
- 2) Press on the sides of the front protective cover and pull to remove it.

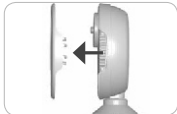

- 3) Press and hold the (PROG) button on the already assigned RTS control point until the end-product moves back and forth: the motor or RTS receiver RTS enters programming mode for 2 minutes.

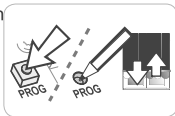

- 4) Briefly press the (PROG) button on the Sunis Indoor WireFree™ RTS. The end-product moves back and forth: the Sunis Indoor WireFree™ RTS is programmed.

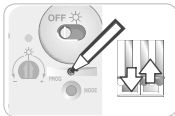

Repeat operations 3 and 4 for each of the end-products to be assigned to this sensor.

5.3. Positioning of the Sunis Indoor WireFree™ RTS

- ⚠ Clean the surface on which the sensor is to be mounted.
- ⚠ Check that there is nothing that can cast a shadow on the sensor.

5.3.1. On an inside window sill

- 1) Screw the suction cup to the bottom of the sensor (A).
- 2) Moisten the suction cup.
- 3) Position the sensor with the sunlight intensity detection area (B) towards the exterior and press on the sensor to fix it in place.

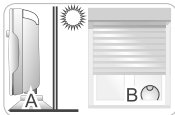

5.3.2. On the inside surface of a window

- 1) Screw the suction cup to the back of the sensor (C).
- 2) Moisten the suction cup.
- 3) Position the sensor below the area to be protected by the end-product (D) and press on the sensor.

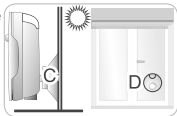

5.4. Sunlight simulation

If you turn the potentiometer to the (-) position, the sensor simulates continuous sunlight, the LED glows green and the end-product is lowered, stops level with the sensor and is then raised slightly above the level of the sensor.

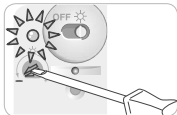

⚠ Do not leave the sunlight threshold setting at this level.

5.5. (Mode) button

- Briefly press the (Mode) button to activate information mode.
- Press and hold the (Mode) button to activate demonstration mode.

5.5.1. Information mode

- Briefly press the (Mode) button to find out the status of the sensor. If the LED (red/green) flashes: the sensor is in demonstration mode. If the LED (red/green) is permanently lit: the sensor is in operating mode. If the LED is red: the level of sunlight intensity is lower than the set sunlight threshold. If the LED is green: the level of sunlight intensity is greater than the set sunlight threshold.

5.5.2. Demonstration mode

The very short response times in demonstration mode make it possible to check the installation.

- ⚠ Do not change the sunlight threshold setting in demonstration mode.
- The same procedure is used to activate or deactivate demonstration mode.

- Press and hold (>2 sec.) the (Mode) button to activate or deactivate demonstration mode. If the red/green LED flashes for a few seconds (30 sec.) then demonstration mode is activated.

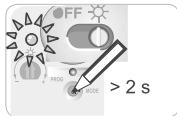

If the red/green LED is lit permanently, then demonstration mode is deactivated.

- If none of the buttons is pressed for 3 minutes in demonstration mode then the sensor automatically switches to operating mode.

5.6. Setting the sunlight threshold

- To increase the sunlight threshold, turn the potentiometer setting toward the (+). To decrease the sunlight threshold, turn the potentiometer setting toward the (-).

To adjust the threshold according to the sunlight intensity of the moment, follow the steps below:

- 1) Slide the (OFF/☀️) selector switch to ☀️.
- 2) Briefly press the (Mode) button: the LED glows green or red.
- 3) Turn the potentiometer up to the (+) position: the LED glows red.
- 4) Slowly turn the potentiometer towards the (-) position until the LED changes from red to green: the sunlight threshold is set on the basis of the current intensity.

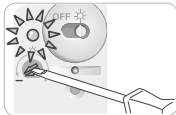
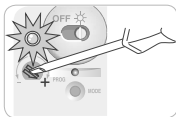
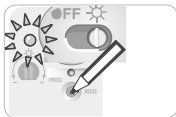

- The LED is red when the sunlight is not strong enough to trigger a command to lower the end-product.
- The LED is green when there the sunlight is strong enough to trigger a command to lower the end-product.

6. Use

⚠ Slide the (OFF/☀) selector switch to ☀.

⚠ Make sure that demonstration mode is not activated.

⚠ Make sure that sunlight simulation is not activated.

If the sunlight intensity is greater than the set sunlight threshold for more than 5 min. (5 sec. in demonstration mode), the end-product is lowered, stops at the level of the sensor and is then raised to slightly above the level of the sensor.

If the sunlight intensity falls below the set sunlight threshold for more than 30 min. (30 sec. in demonstration mode), then the end-product is fully raised.

If the sunlight intensity rises above sunlight threshold during this operation, then the end-product stops.

⚠ If the sunlight intensity falls below the set sunlight threshold again, the end-product is raised fully even if the sunlight level rises above the set value during the raise operation. The end-product will not be lowered again during the day or will not be lowered again until the sun has disappeared and reappeared.

Time:

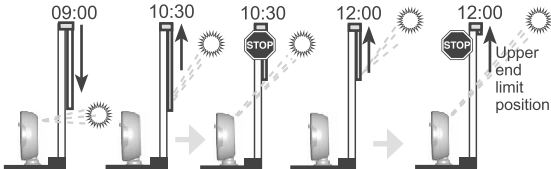

- If the end-product is lowered manually (e.g. using a remote control) or automatically (e.g. using a timer) and the sensor is no longer exposed, then the sunlight detection function is deactivated until the end-product is opened again manually or automatically.
- The LED glows orange when the battery is weak.

7. Tips and recommendations

7.1. Questions about the Sunis Indoor WireFree™ RTS?

Observations	Possible causes	Solutions
The end-product does not react to sunlight.	The sensor is off.	Slide the (OFF/☀) selector switch to ☀.
	The sensor is not programmed.	See the section "Adding/Deleting a Sunis Indoor WireFree™ RTS".
	The sunlight threshold is not set correctly.	Set the sensitivity level again.
	The battery is weak.	Replace it.
	The sensor is dirty.	Clean the sensor.
	The sensor is poorly positioned.	Reposition the sensor.
The end-product reacts too often.	The sensor is in "Demonstration mode" or "Simulation mode".	Deactivate the "Demonstration mode" or sun "Simulation mode".
The end-product reacts abnormally.	A light source is interfering with the sensor.	Move the light source.

7.2. Replacing the battery

1) Unclip the front protective cover.

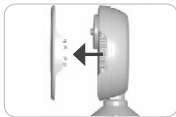

2) Open the sensor.

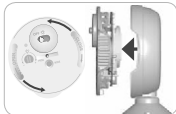

3) Push the used battery out of its housing using a plastic object.

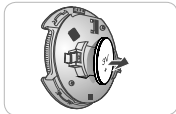

4) Insert a battery with identical specifications, ensuring that the face marked with a plus sign (+) is visible.

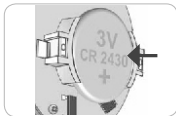

5) Push the battery fully into its housing.

6) Close the sunlight sensor.

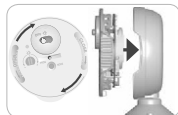

7) Clip the front protective cover back on.

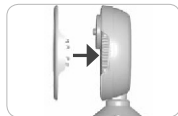

8. Technical data

Radio frequency	433.42 MHz
Power supply	1 x 3V battery type CR 2430
Safety level	Class III
Operating temperature	0°C - +60°C (32°F - 140°F)
Protection class	IP 31
Adjustable sunlight threshold (min. - max.)	5 kLux - 30 kLux

Batteries or accumulators have to be separated from other type of waste and must be recycled through your local treatment and recycling system.

